

Mieszkanie M02 ● powierzchnia 40,15 m<sup>2</sup> ● Parter

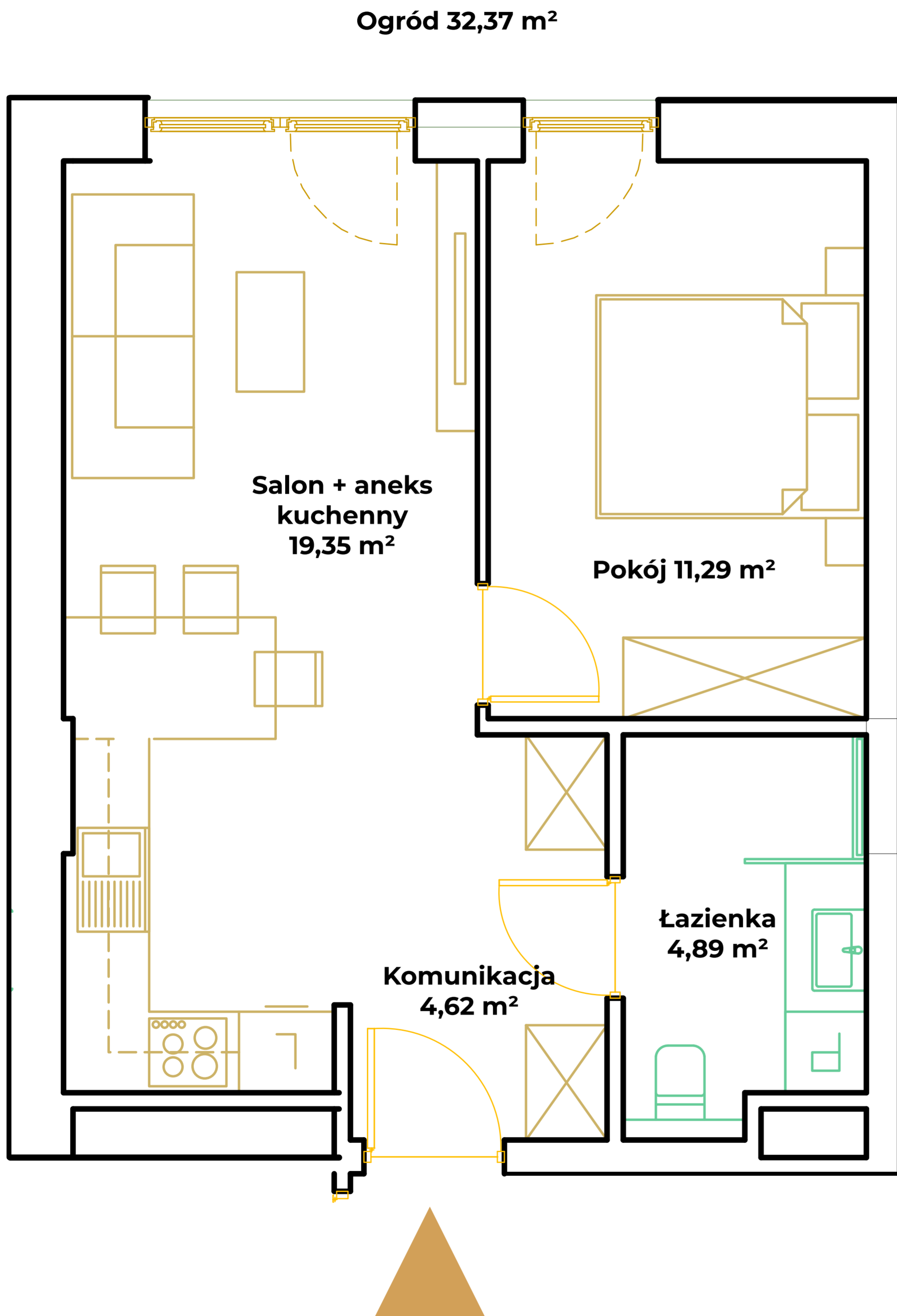

↑  
N

**GLINIKI**  
NOWY TARG

tel. +48 **785 800 900**  
**gliniki.pl**

The right side of the image features a site plan of the building, with the specific apartment unit highlighted in brown. Above the site plan is a north arrow pointing upwards, labeled 'N'. Below the site plan is the 'GLINIKI' logo, which consists of stylized building icons above the company name in a serif font. Underneath the logo, the text 'NOWY TARG' is written in a smaller, spaced-out font. At the bottom of this section, the contact information is provided: a phone number '+48 785 800 900' and the website 'gliniki.pl'.