

Mieszkanie M46

powierzchnia 27,23 m<sup>2</sup>

IV piętro

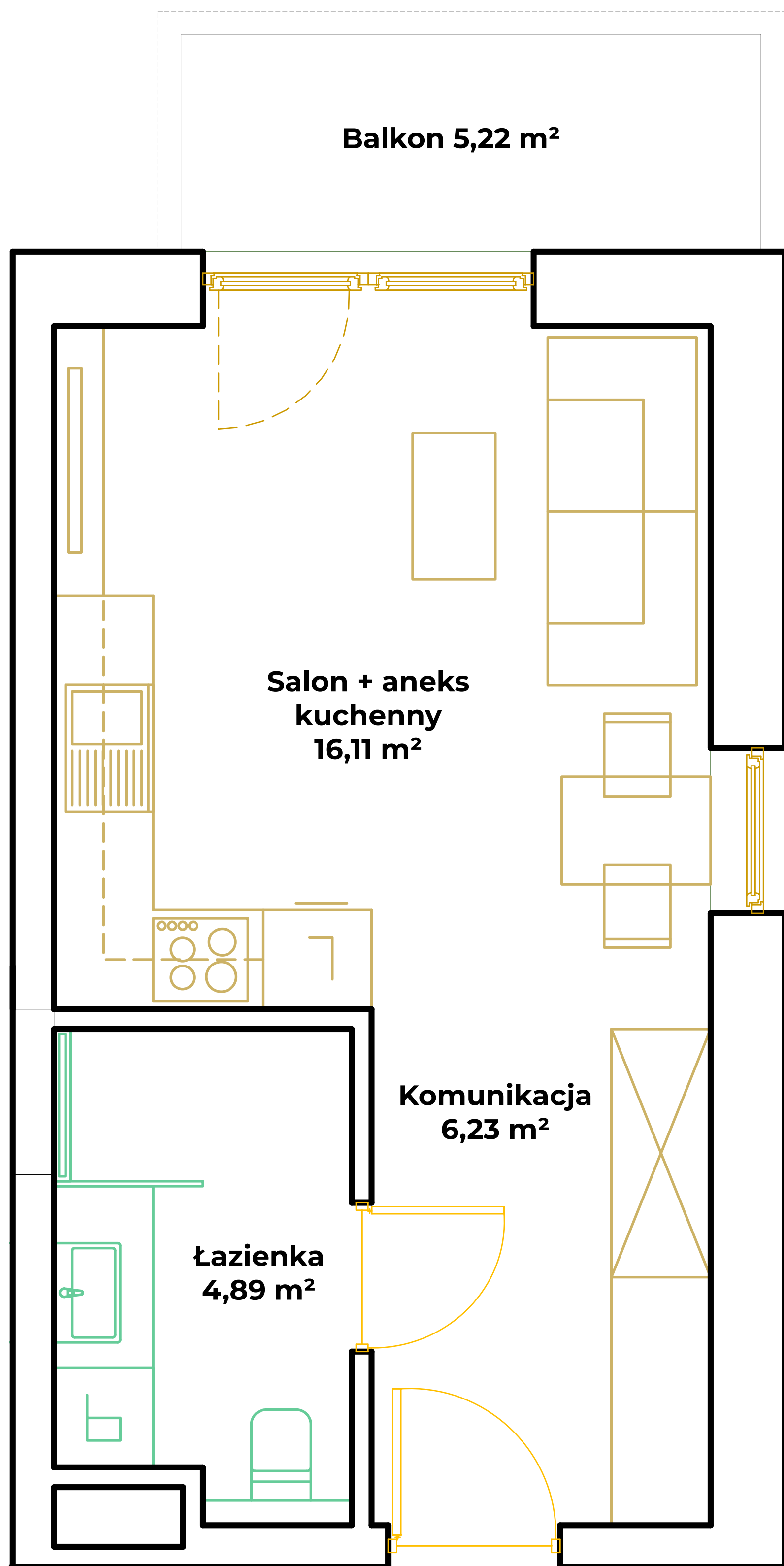

↑  
N

**GLINIKI**  
NOWY TARG

tel. +48 **785 800 900**

**gliniki.pl**

The right side of the image features a black background with a white orientation map of the building's floor plan. A north arrow is located in the top right corner. Below the map is the logo for 'GLINIKI NOWY TARG', which includes a stylized building icon. At the bottom, the contact information is provided: the phone number '+48 785 800 900' and the website 'gliniki.pl'.